



50 x 10ft WIDEBEAM

50ft, ABC Boats, 2014, Widebeam Style Boat



BERTHS:

2



TOILET:

Porta potti



HEATING:

Webasto



SURVEY:

-



B.S.C:

New with Sale



BLACKING:

2022



ENGINE:

Barrus shire 50hp



LAYOUT:

Standard

Boat Specification

Plating Specification	10/6/5/4
Flat, V-Hull or Keeled	Flat Hull
Fitted out By	Owner
Fixed Berths	Fixed double
Additional Berths	-

Engine Specification

Engine Make	Barrus shire 50hp
No. Of Cylinders	4
Keel, Water or Air Cooled	Keel Cooled
Gearbox Make	Prm 150
Aqua Drive	No
Bow Thruster	No
Diesel Tank Capacity	300 litres approx

Hot Water & Heating Systems

Source of Hot Water	Engine Webasto
Central Heating	Webasto
Solid Fuel Stove	Yes
Water Tank Capacity	700 litres approx
Material used	Polypropylene
Additional Systems	-

Electrical System & Components

12 Volt Lighting	Yes
240 Volt Landline	Yes
Inverter	-
Generator	-
Batteries	3 domestic, 1 starter
Additional Systems	-

Bathroom Specification

Type Of Toilet	Porta potti
Bath Fitted	No
Separate Shower Fitted	Yes
Vanity Basin Fitted	Yes
Additional Systems	-

Kitchen Specification

Make & Model Of Cooker	Belling
Separate Hob	Belling
Microwave Fitted	-
Make & Model Of Fridge	Yes
Gas, 12 volt or 240 volt	240 volt
Additional Systems	-

Fit Out Materials

Insulation Used
Types Of Wood Used
Window Types
Materials Used
Bulls Eye, Pigeon Box or Houdini Hatch
Exterior Doors
Side Hatches
Front & Back Covers

Spray Foam
Oak ply
Hopper
Gold Anodised
-
Front - Steel, Back - Steel
Yes
Front cratch & cover, rear pram cover

History Of Vessel

Boat Safety Certificate
Last Hull Blacking
Anodes
Further Maintenance
Recent Survey
Additional Information
RCD/RCR Compliant?
Further Information

New with Sale
2022
Checked 2022
-
-
50 x 10ft WIDEBEAM
Yes
PCA carried out 2024 December

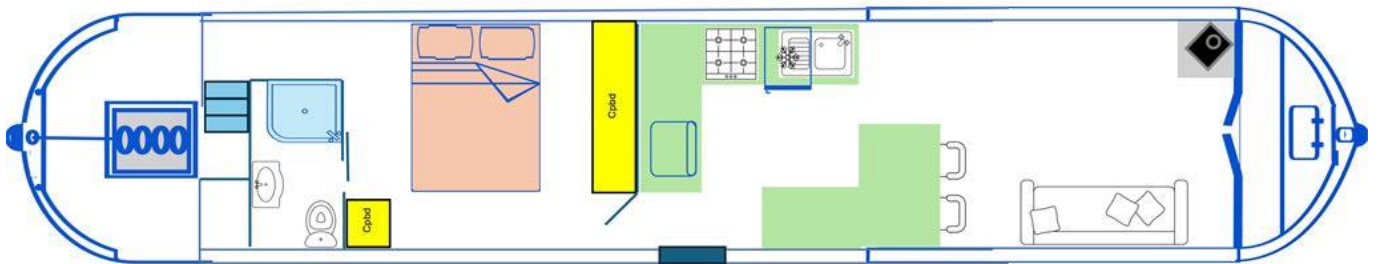



Whilton Locks, Near Daventry,
Northants, NN11 2NH
01327 842577
sales@whiltonmarina.co.uk
www.whiltonmarina.co.uk

For further information please see
a member of the sales team.

It is the responsibility of the buyer to ensure that all particulars given in
the course of the purchase of the boat are accurate. Such particulars are
intended only as a guide and do not constitute a term of any contract.

